

INTEGRAL / WELDED UNION END FITTINGS (FIG. 602, 1002, 1502)

Size: 1" To 6" Upto W.P. 15,000 PSI, T.P. 22,500 PSI For Standard & Sour Service

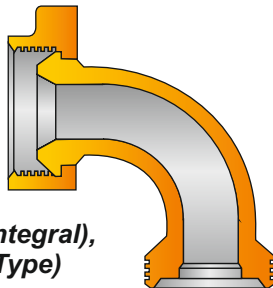

**Corner Joint (integral),
(Split Bush Type)**

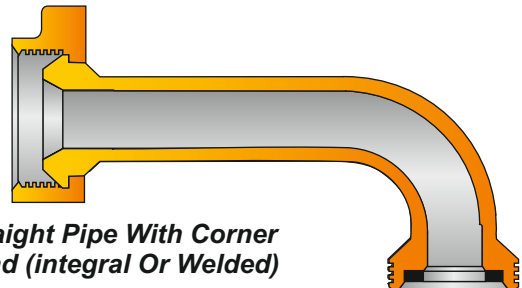

**Straight Pipe With Corner
Bend (integral Or Welded)**

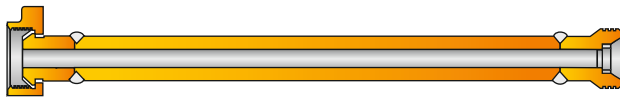

Straight Pipe (integral Or Welded)

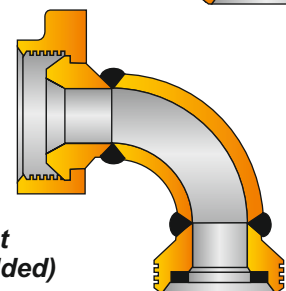

**Corner Joint
(integral Or Welded)**

Block Type Fittings (Welded & Studded Flanged Type) (Up To 30,000 PSI Test Pressure In Any Sizes)

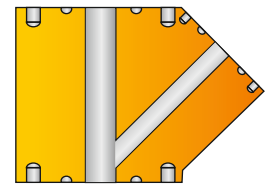
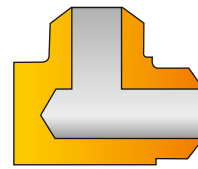
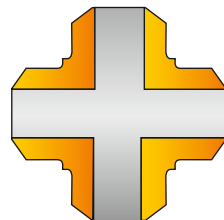
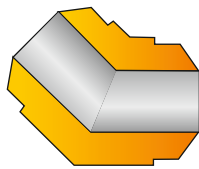
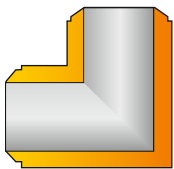

Manifold Fittings (Threaded, Butt Welded & Socket Welded) (Up To 10,000 PSI Test Pressure, Sizes: 2", 3", 4", & 5")

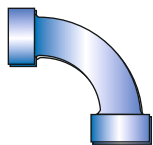

Long Sweep Elbow 90°

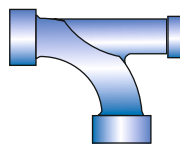

**Long Sweep Elbow
With Two Outlet**

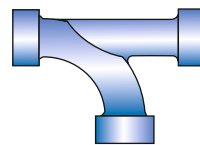

Long Sweep Tee

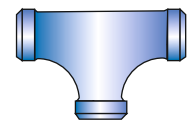

**Long Sweep Full
Flow Tee**

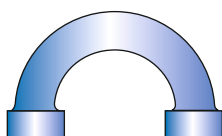

**Standpipe
Gooseneck 180°**

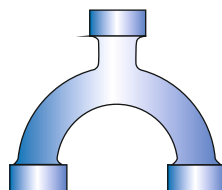

Long Sweep 'Y'

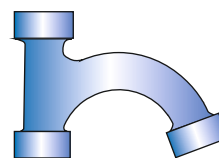

**Standpipe Gooseneck
160°
With Top Outlet**

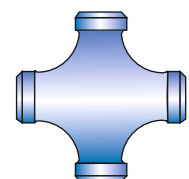

Full Flow Cross

NOTE: For other sizes, pressures and services, consult factory.