

SURFACE FLOW CONTROLS WFC SERIES WATERFLOOD CONTROL VALVES

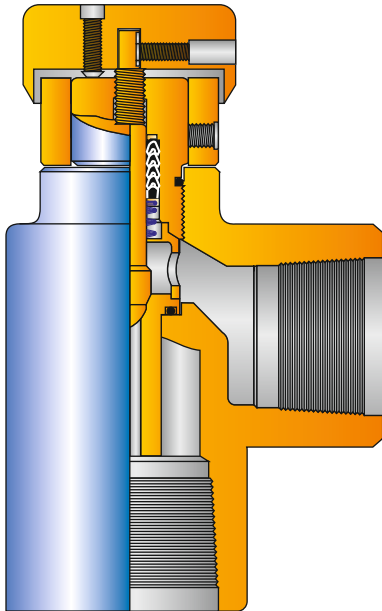

WFC WATERFLOOD VALVE

PARVEEN WFC Waterflood Control Valves are designed specifically for waterflood applications. These are available in either 1 or 2-inch angle body configurations with threaded, butt weld or flanged connections. This design contains a long throat seat to control the turbulence and erosion associated with liquid service. Standard features of this valve include the adjustable hand wheel calibrated in sixty-fourths of an inch and Teflon packing for positive seal and minimum maintenance. An optional feature is the availability of a secondary positive choke bean for high-pressure differentials. This feature is designed for a 60% and 40% pressure drop across the primary and secondary controls respectively.

Stainless steel, hard chrome or tungsten carbide trims are available in 1/8, 1/4, 1/2 and 3/4 inch sizes. The long throat seat, stainless steel handle and indicator ring are standard.

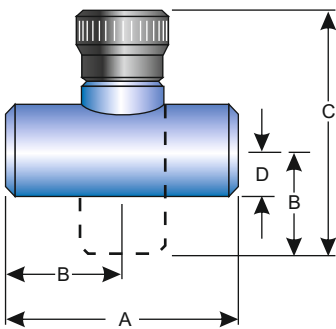

FCV - WFC

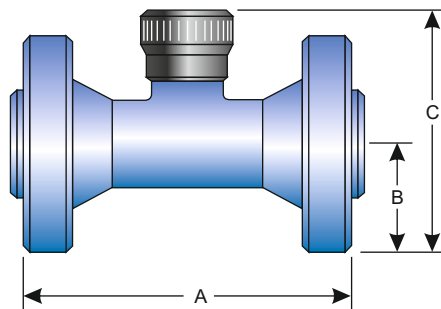

FCV - FLANGED

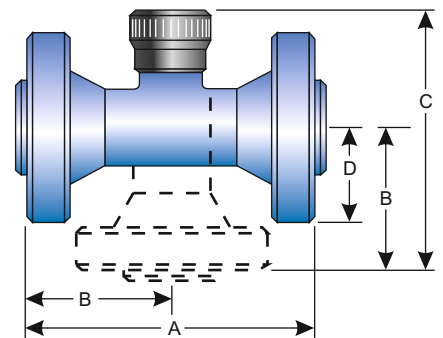

FCV - 2X

DIMENSIONAL DATA FOR FCV, WFC AND FCV-2X

End Connection	Dimensions (Inches)												Approximate Weight in Lbs.		
	A			B			C			D					
Type / Size	1	2	2X	1	2	2X	1	2	2X	1	2	2X	1	2	2X
Screwed	6.30	7.80		2.95	3.90		7.90	8.81		1.06	1.72		10	20	
Butt Weld	5.00	6.75		2.50	3.37		7.45	8.65		1.06	1.72		10	20	
Socket Weld	5.12	6.75		2.56	3.37		7.51	8.65		1.06	1.72		10	20	
Series 150 RF		9.00			4.50			9.78			3.00			32	
Series 300 RF		10.00		5.00				10.28			3.25			32	
Series 600 RF	8.50	11.50	11.50	4.25	5.75	5.75	9.20	11.03	9.65	2.44	3.25	3.25	18	40	34
Series 600 RJ	8.50	11.62	11.62	4.25	5.81	5.81	9.20	11.09	9.71	2.44	3.25	3.25	18	40	34
Series 1500 RF	10.00	14.50		5.00	7.25		9.95	12.53		2.94	4.25		30	70	
Series 1500 RJ	10.00	14.62		5.00	7.31		9.95	12.59		2.94	4.25		30	70	
Series 900 RF	10.00	14.50	14.50	5.00	7.25	7.25	9.95	12.53	11.25	2.94	4.25	4.25	30	70	
Series 900 RJ	10.00	14.62	14.62	5.00	7.31	7.31	9.95	12.59	11.21	2.94	4.25	4.25	30	70	90
API 3000		14.62			7.31			12.59			4.25			70	
API 5000		14.62			7.31			12.59			4.25			70	